

Hull Royal Infirmary Masterplan Part 4

4.3.2 Draft Proposal General Arrangement Plan

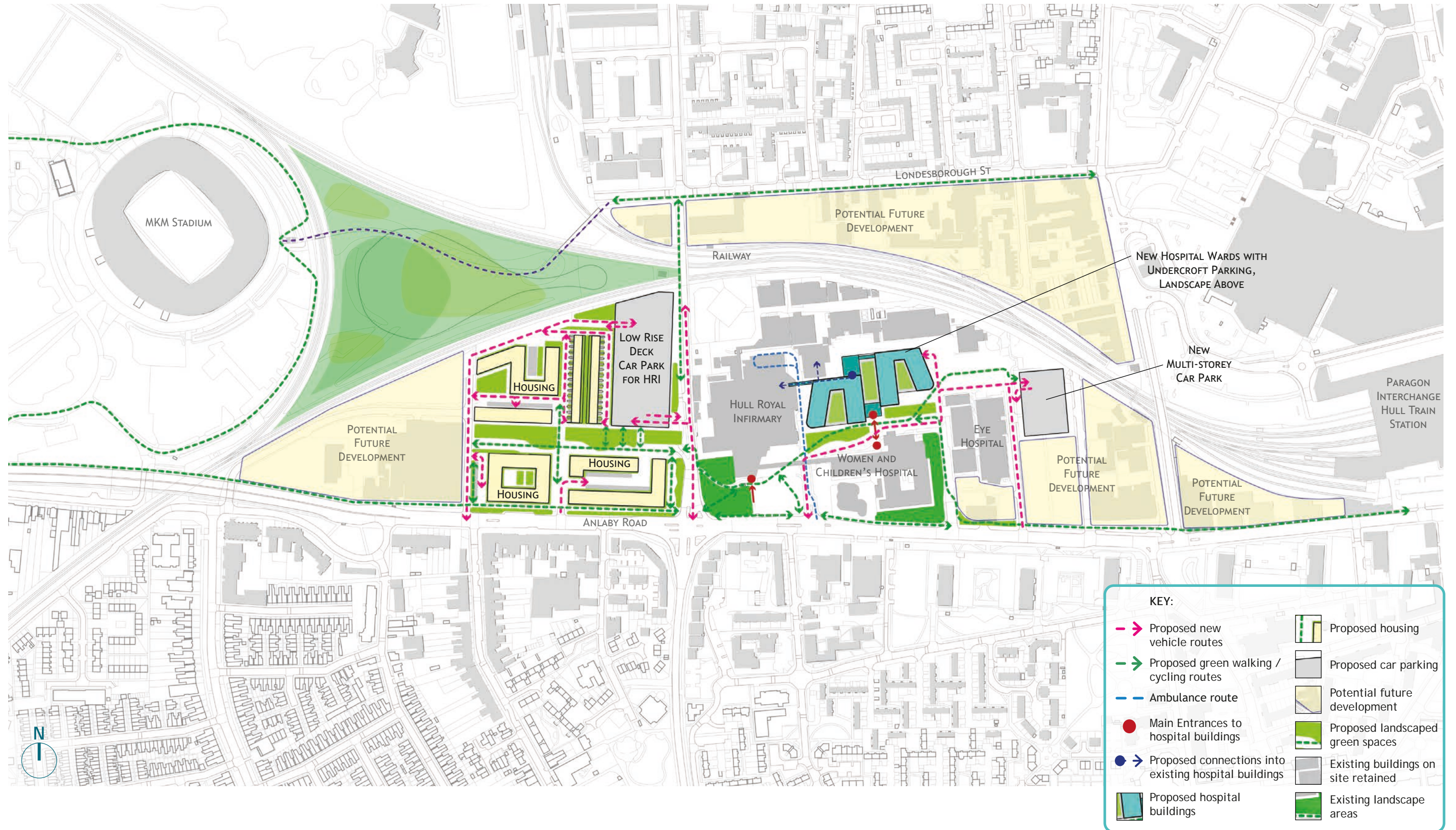

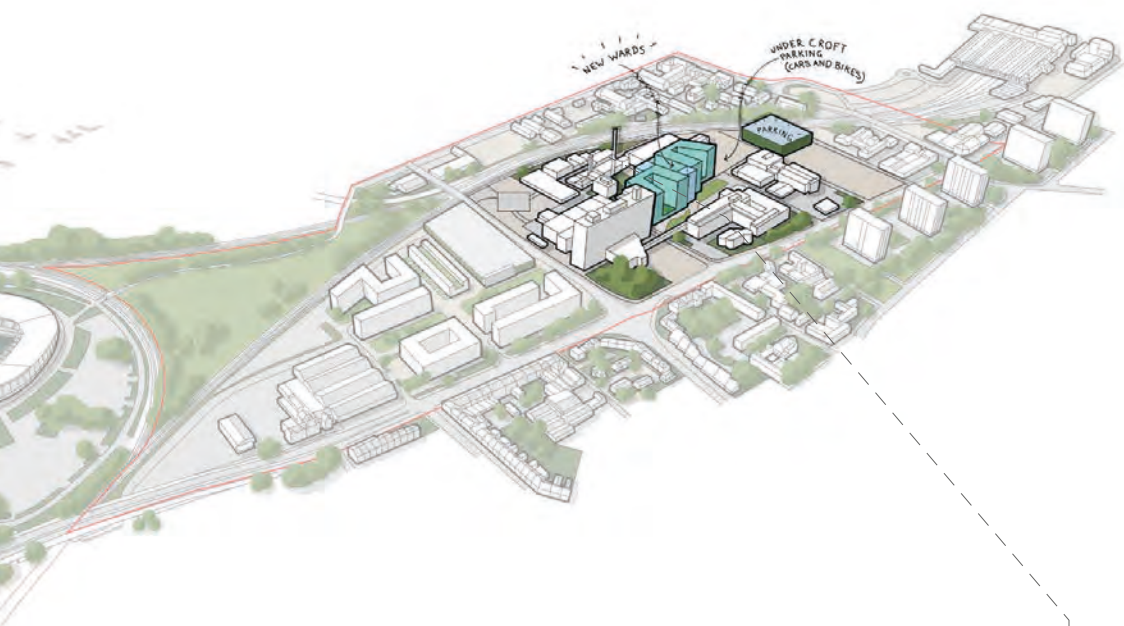

Bright Building, Manchester: example of SUDS & greening in public realm

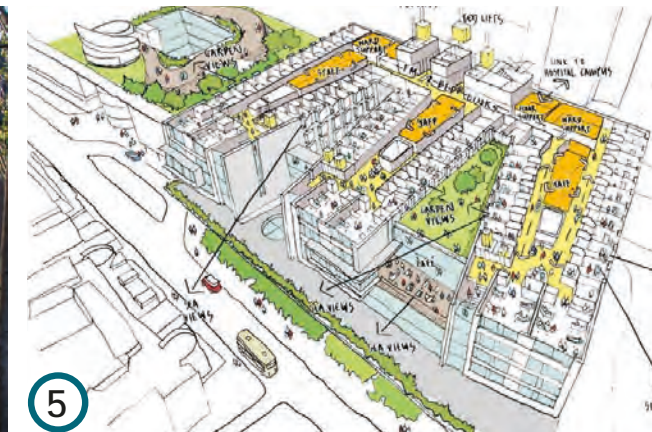

Brighton 3T's: precedent where hospital wards were orientated facing garden views



Southmead Hospital: example of opportunity for private ward gardens

Precedent Images

Healthcare Site: Key Aims

- Provide high quality accommodation to replace the existing ward tower as part of the Nationwide New Hospital Programme.
- Add green space amenity where possible on the constrained existing estate.
- Create a sustainable travel route across the HRI estate, linking to Anlaby Road but providing a secondary additional route.
- Preserve current surface car-parking numbers where needed, such as those convenient to Women & Children's Hospital.
- Tie new wards into existing key facilities of Theatres, Intensive Care Unit & Imaging.
- Improve existing flood risk to HRI estate and mitigate flood risk to new accommodation.
- Separate the front-of-house entrance space from back-of-house service area.
- Make sustainable travel routes prominent and visible across the site.

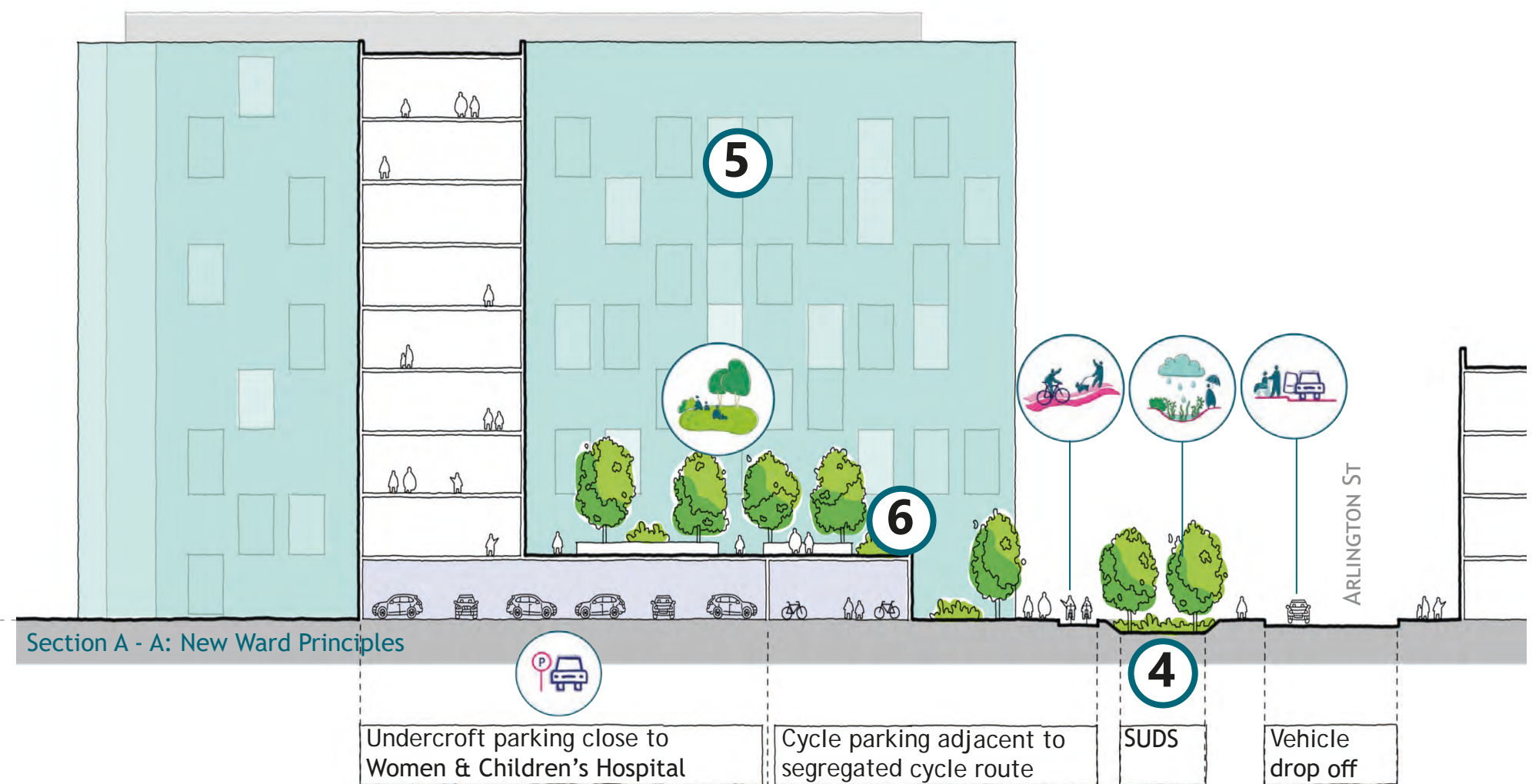

4.3.4 Housing Proposal

