

TPO 224
Calvert Lane

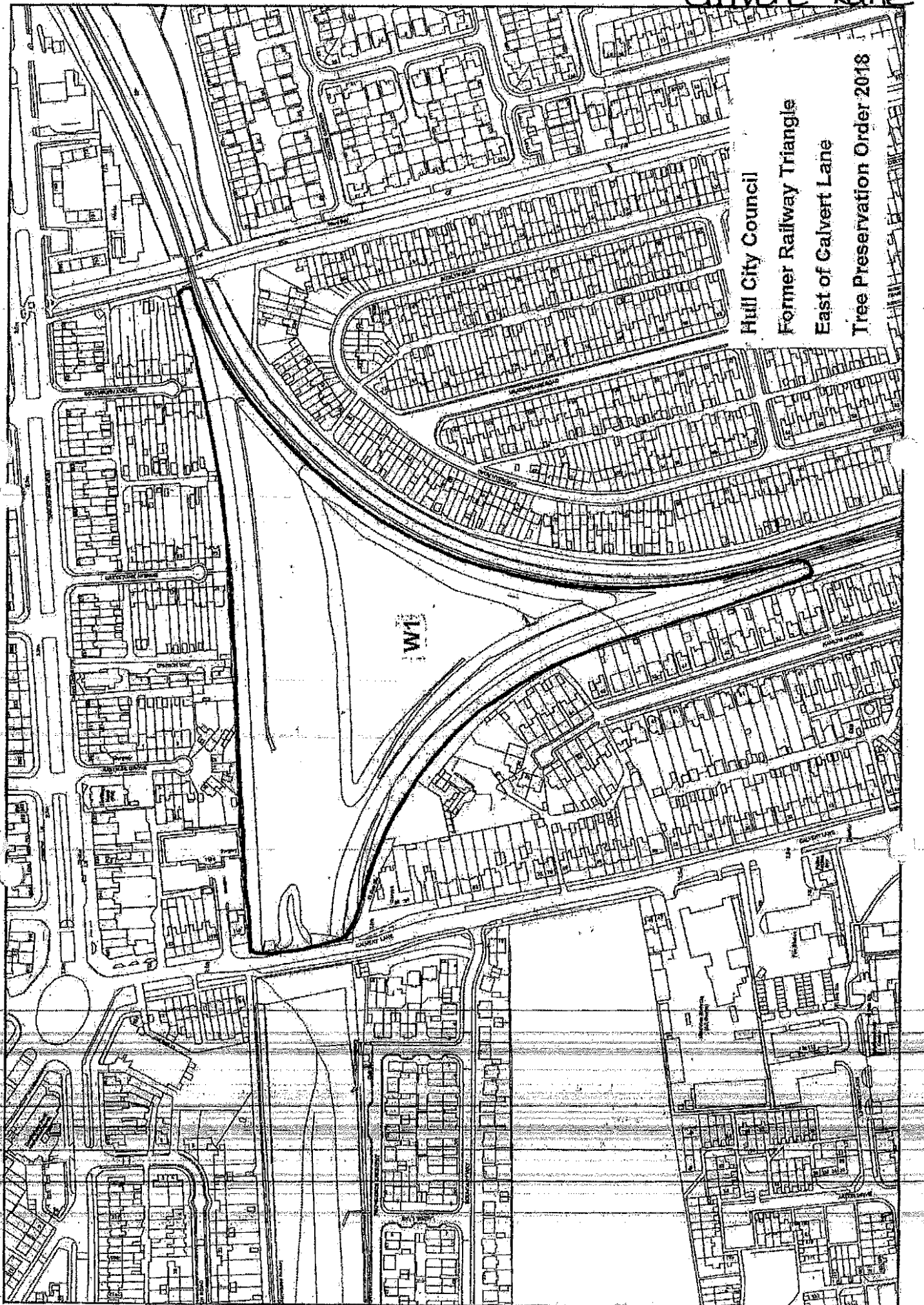

Hull City Council
Former Railway Triangle
East of Calvert Lane
Tree Preservation Order 2018

W1

TPO 267

MARINA COURT

CASTLE STREET

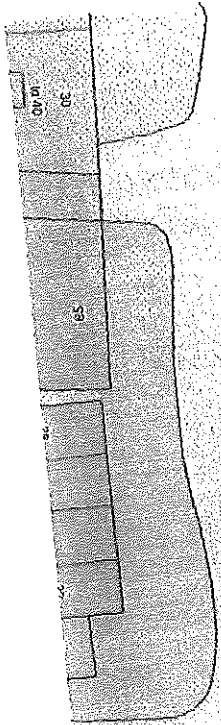

FISH S

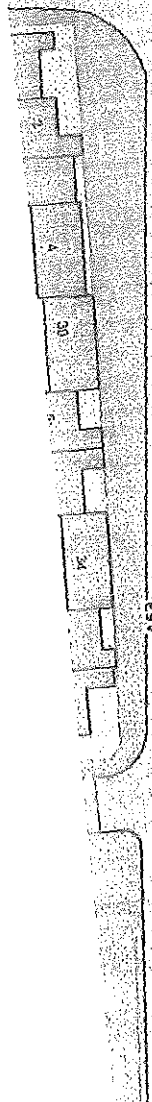

AGE

Line 21

LE STREET

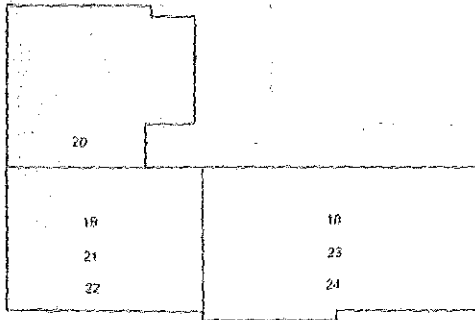

IN LANE

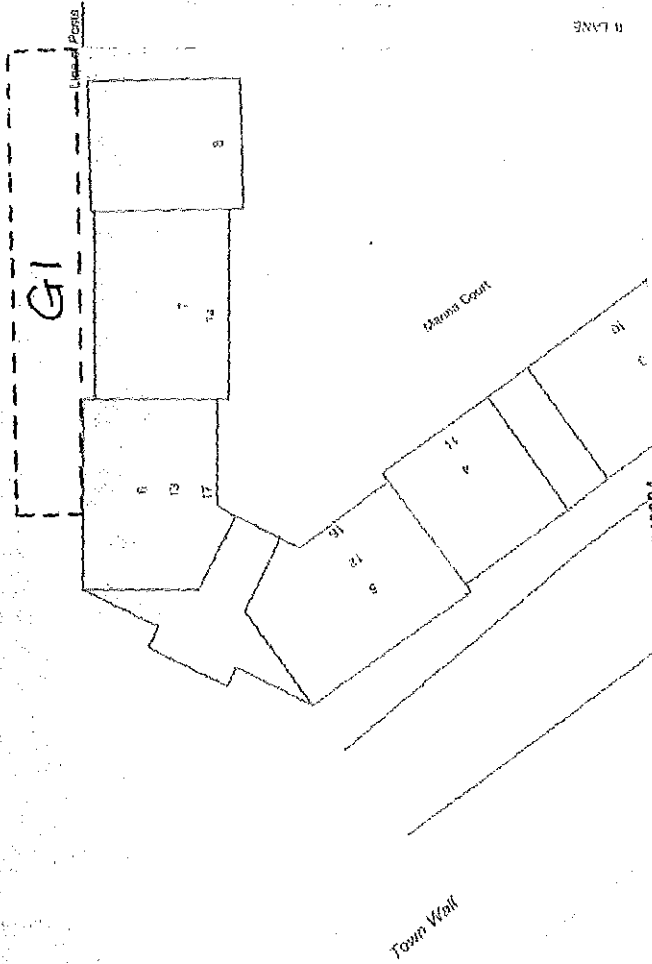

Copyright and database rights 2023 Ordnance Survey AC0000849994

TPO 117 Chamberlain Road Recreation Ground



Not Set

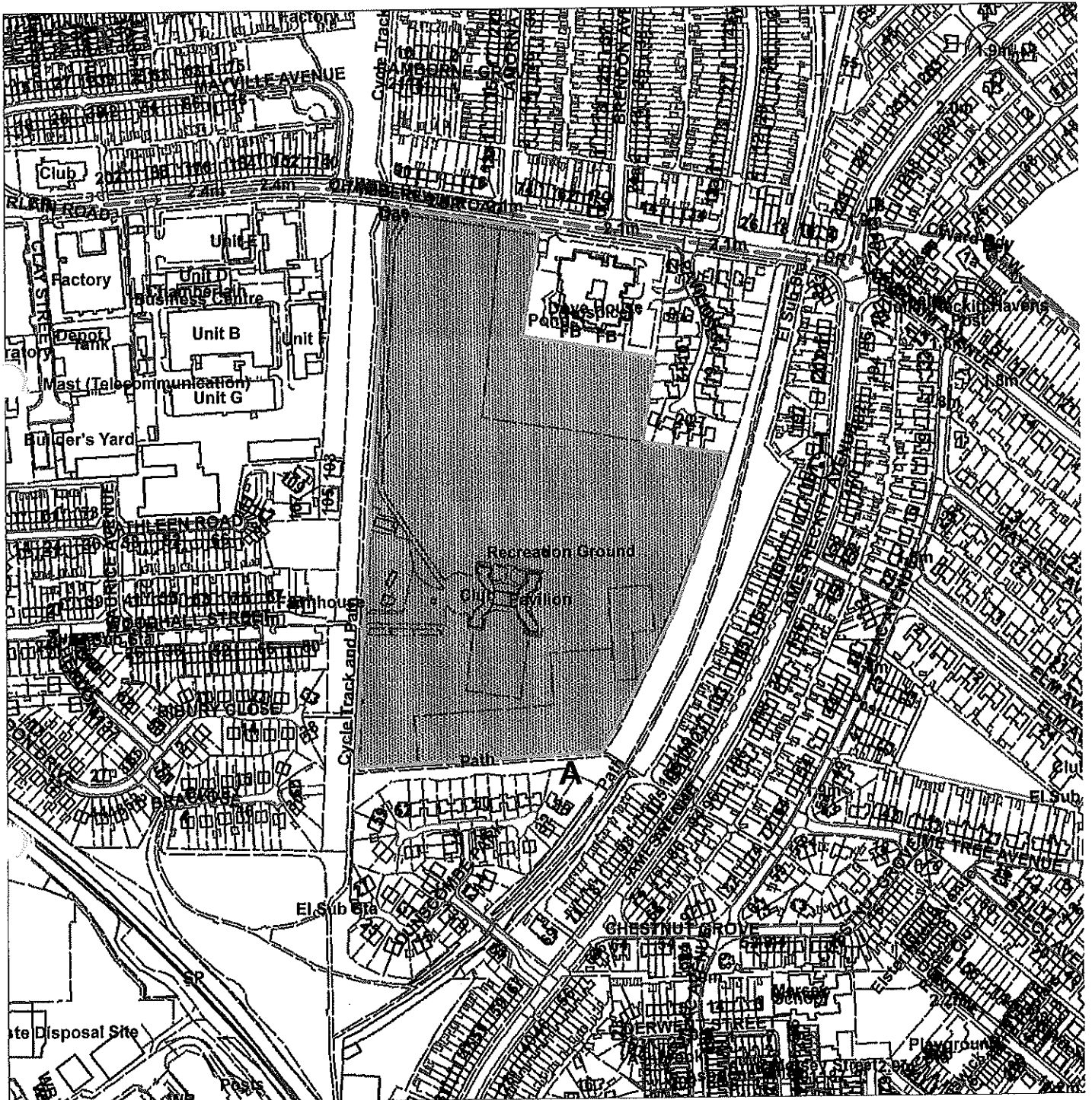

Scale : 1:4252

Organisation	Hull City Council
Department	Planning Department
	Not Set
Date	27 April 2015



Reception Consultation

Reception Details Orders Actions Map Print Index

Order No.	<input type="text" value="02/00117/TPO"/>	U.P.R.N.	<input type="text" value="000021137711"/>
Type	<input type="text" value="TPO - Tree Preservation Order"/>	Address	<input type="text" value="Recreation Ground
Chamberlain Road
Kingston Upon Hull
HU8 8HW"/>
Status	<input type="text" value="CONF - Order Confirmed"/>		
Map Ref. (E)	<input type="text" value="510832"/> (N) <input type="text" value="430856"/>		

Title

Contact Details

Reference	<input type="text"/>	Date Received	<input type="text" value="23.10.2002"/>
Contact Type	<input type="text"/>	Officer	<input type="text"/>
Name	<input type="text"/>	Ward	<input type="text" value="11 - Drypool"/>
Address	<input type="text"/>	Parish	<input type="text" value="RIVERS"/>
Contact	<input type="text"/>	Conservation Area	<input type="text"/>
		BC Refs	<input type="text"/>
		DC Refs	<input type="text" value="01/00954/PF"/>
		TP Refs	<input type="text"/>

Sequence	Reason
<input type="text"/>	<input type="text"/>



Save Exit

Reception Consultation

Reception Details Orders Actions Map Print Index

Order No.	02/00117/TPO	Address	Recreation Ground Chamberlain Road Kingston Upon Hull HUB 8HW
U.P.R.N.	000021137711		
Status	CONF - Order Confirmed		
Title	This Order may be cited as The Kingston upon Hull (Chamberlain Road, Brooklands Recreation Ground) Tree Preservation Order No 117, 2002		

Category	Category Nos.	Contained In	Count	Species	Map Ref (E)	Map Ref (N)	Date Removed
Description				Situation			
Area			A1	VARIOUS - A variety of Tre	510805	430888	

Navigation icons: Home, Back, Forward, Stop, Refresh

Save Exit

My Diary Graphs TPO

Order No.	02/00117/TPO	Address	Recreation Ground Chamberlain Road Kingston Upon Hull HUB 8HW
U.P.R.N.	000021137711		
Status	CONF - Order Confirmed		
Title	This Order may be cited as The Kingston upon Hull (Chamberlain Road, Brooklands Recreation Ground) Tree Preservation Order No 117, 2002		

Objections Deadline	23.04.2003	Officer		Committee Date	
Provisional Order Date	23.10.2002	Provisional Expiry Date	24.10.2002	Approved Y/N	Y <input type="checkbox"/> Agenda <input type="checkbox"/>
Date Confirmed	05.03.2003	Type of Order	CONFIR - Confirmation c	Date Served	23.10.2002
Date Closed		Reason Closed		Last Letter Sent	

Notified		Notified Type		Object Y/N	<input type="checkbox"/>
Address		Letter Type		Date Printed	
Type		Date Sent		Date Reply Rec.	

Modifications	Date Modified	Modification	Reason
Modified? <input type="checkbox"/>			

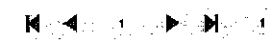

Save Exit

TPO 179 446 Chanterlands Avenue

Not Set

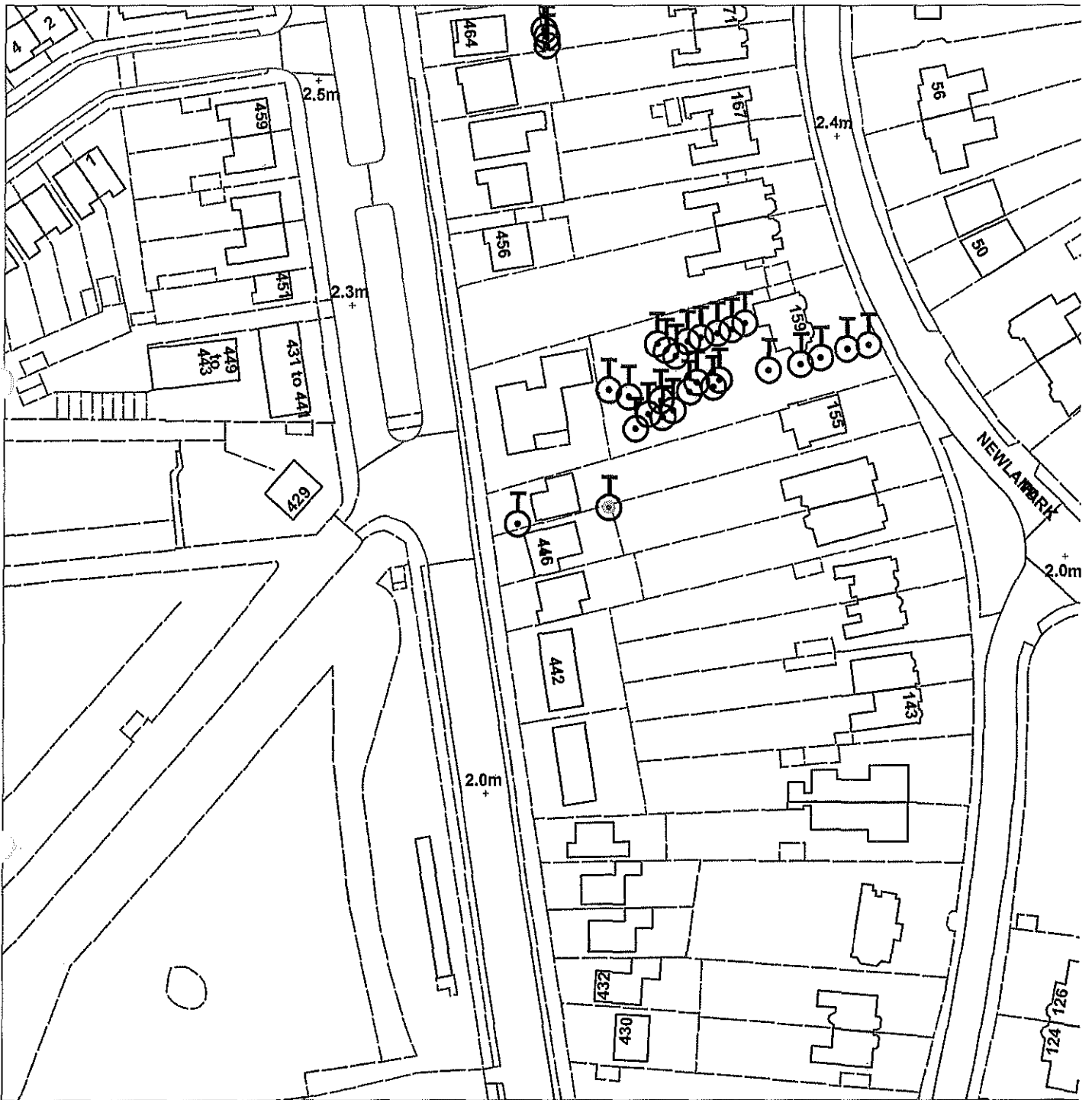

Scale : 1:1248

Organisation	Hull City Council
Department	Planning Department
	Not Set
Date	27 April 2015

TPO 163 448 Chanterlands avenue

Not Set

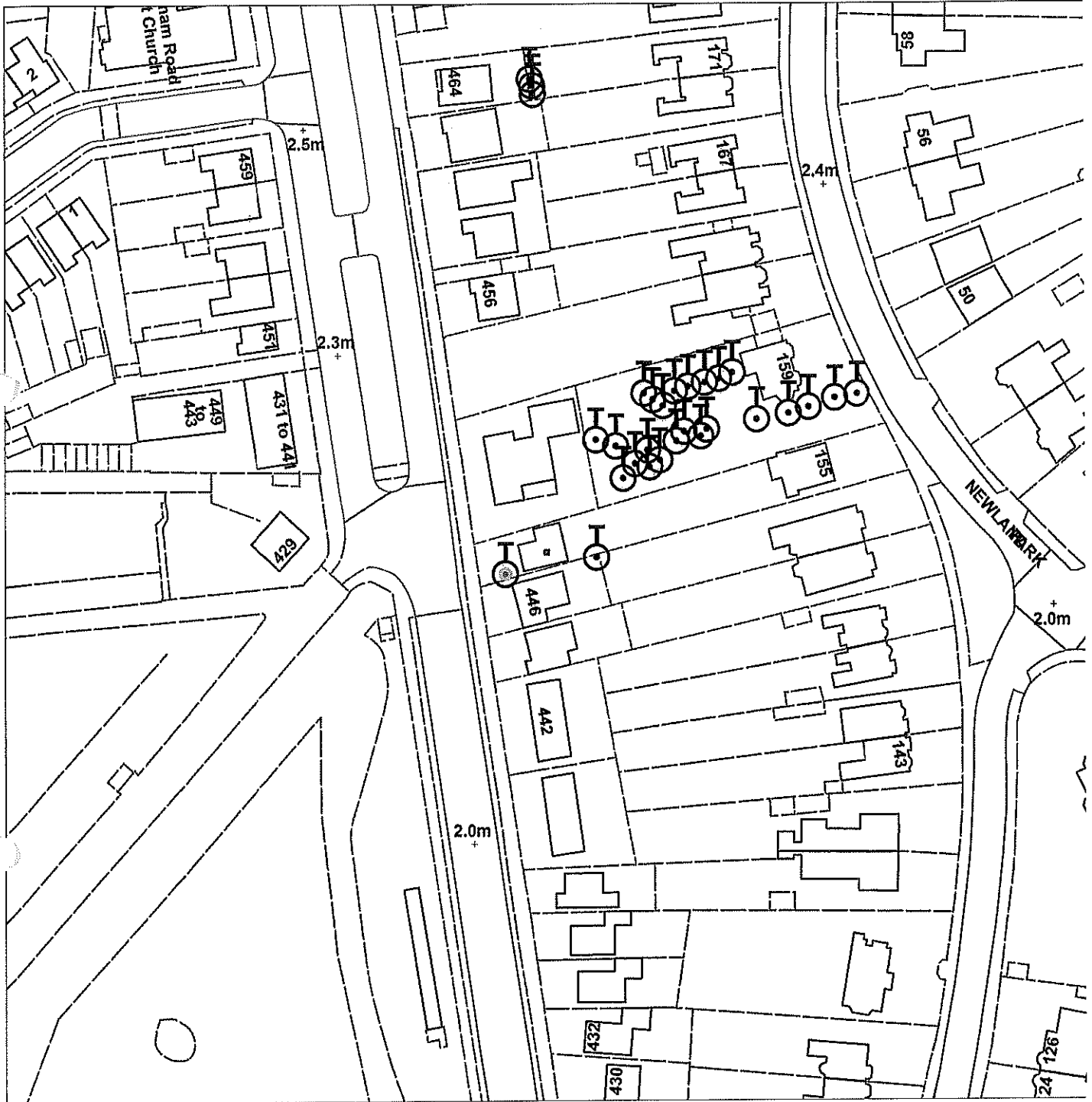

Scale : 1:1248

Organisation	Hull City Council
Department	Planning Department
	Not Set
Date	27 April 2015

TPO 172 1 Cherry Tree Avenue

Not Set



Scale : 1:1248

Organisation	Hull City Council
Department	Planning Department
	Not Set
Date	27 April 2015

TPO No. **273**

Mona House, Leads Road
Church Street

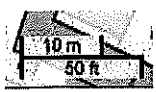
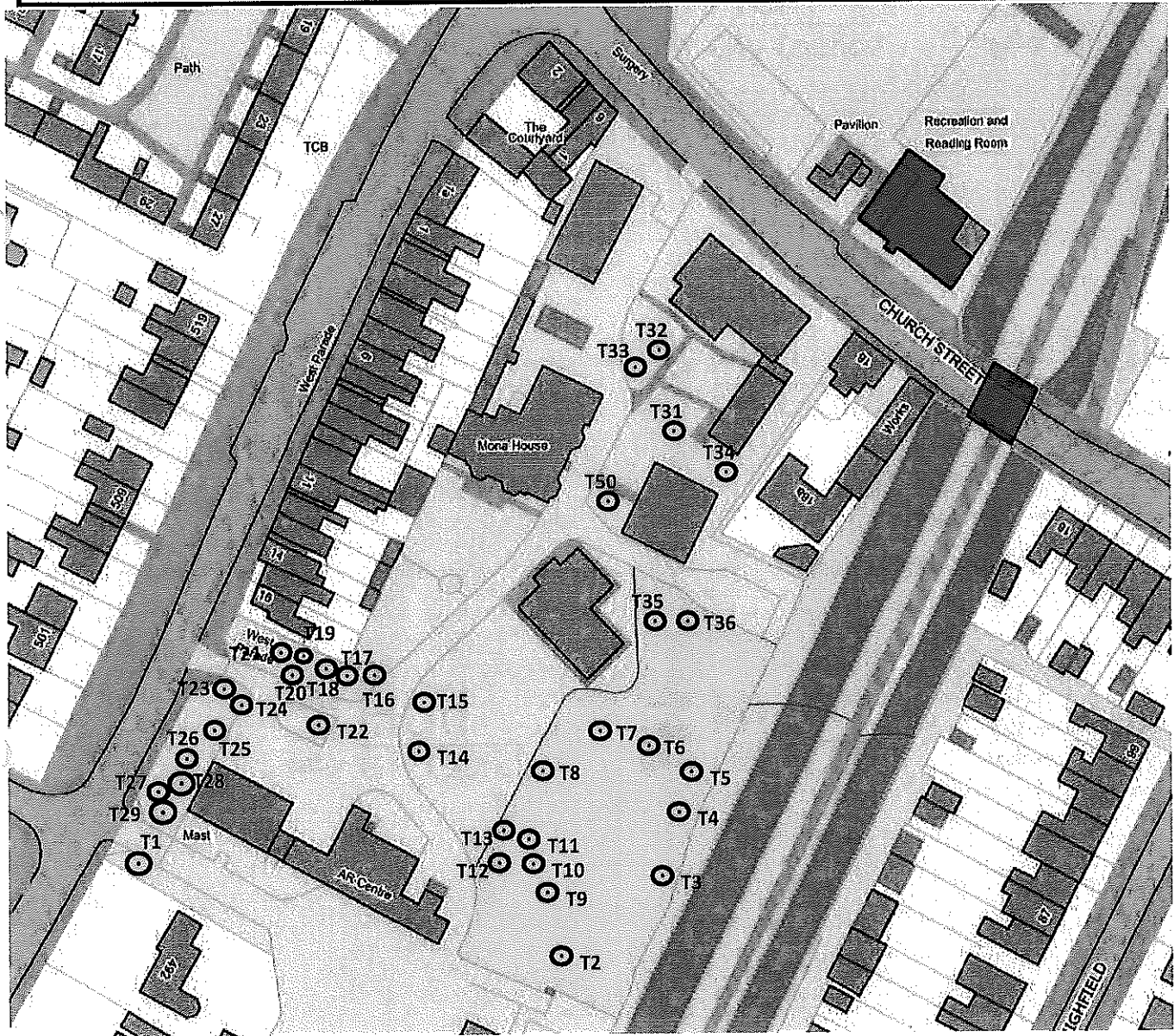

TPO 168 Crosby Hall Church Lane

Not Set

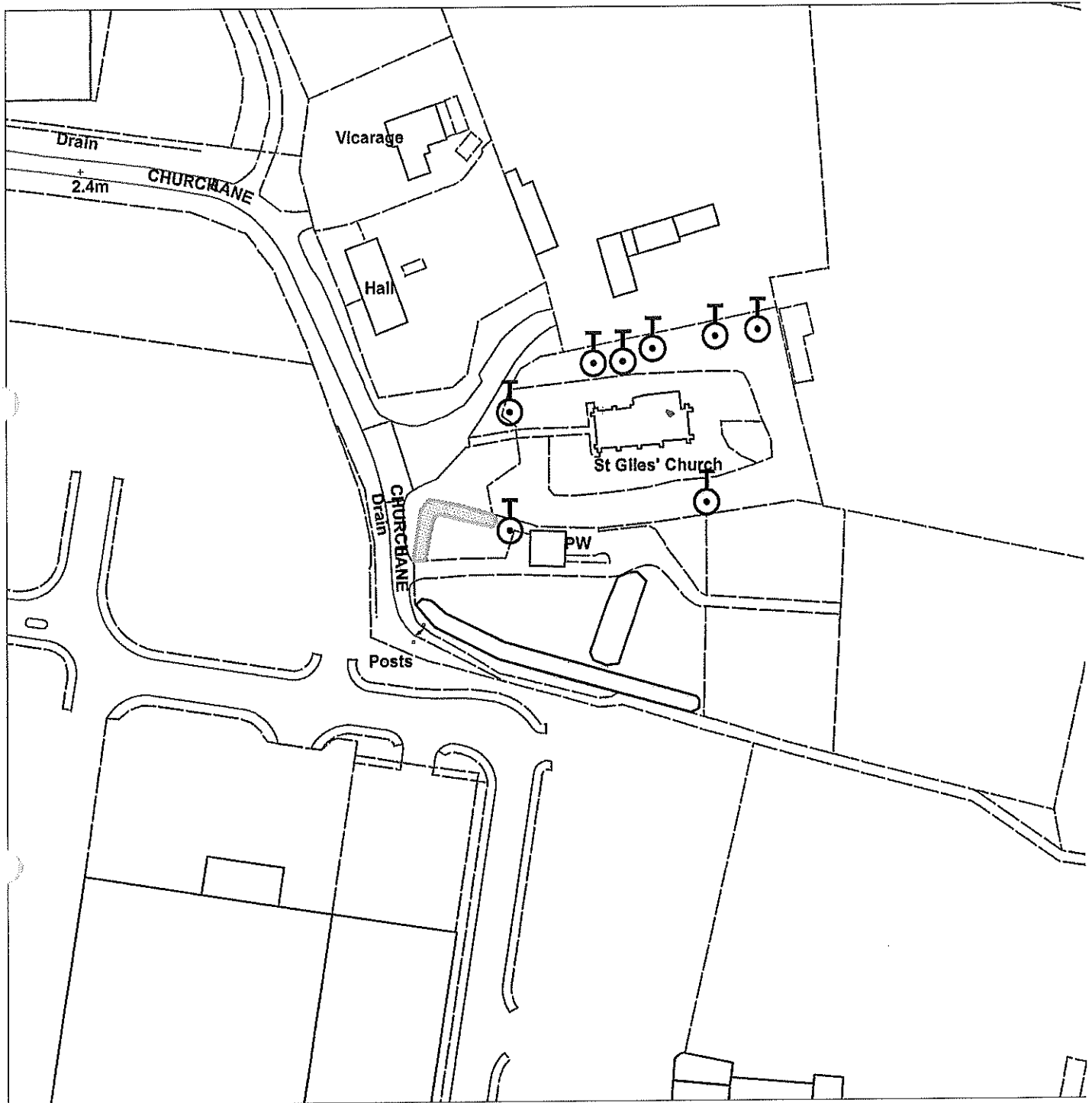

Scale : 1:1248

Organisation	Hull City Council
Department	Planning Department
	Not Set
Date	27 April 2015

4 Church
Mount.
TPO 235



Church Mount

TPO 167 10 Church Mount

Not Set

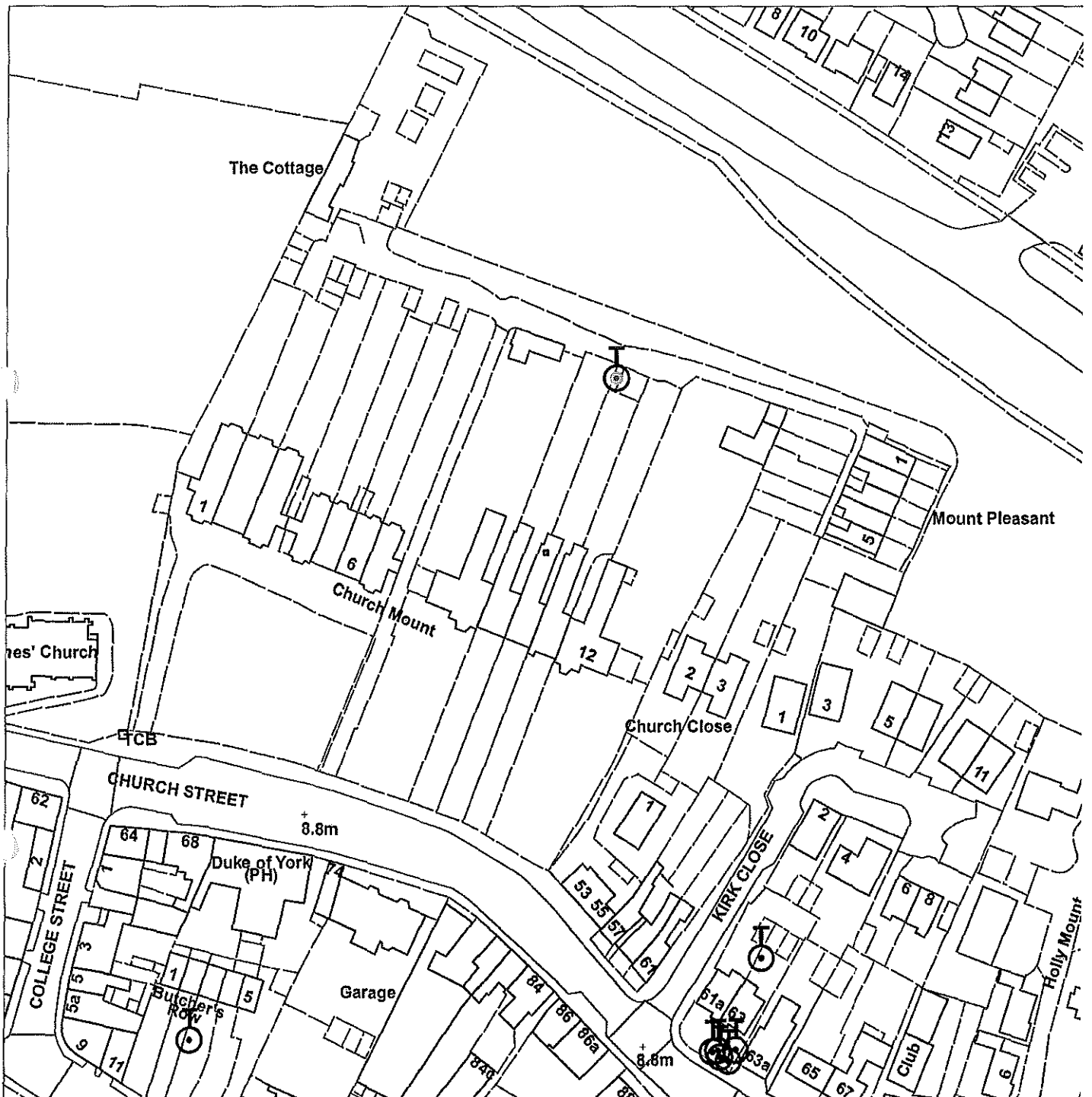

Scale : 1:1248

Organisation	Hull City Council
Department	Planning Department
	Not Set
Date	27 April 2015

TPO9A 63 Church Street

Not Set

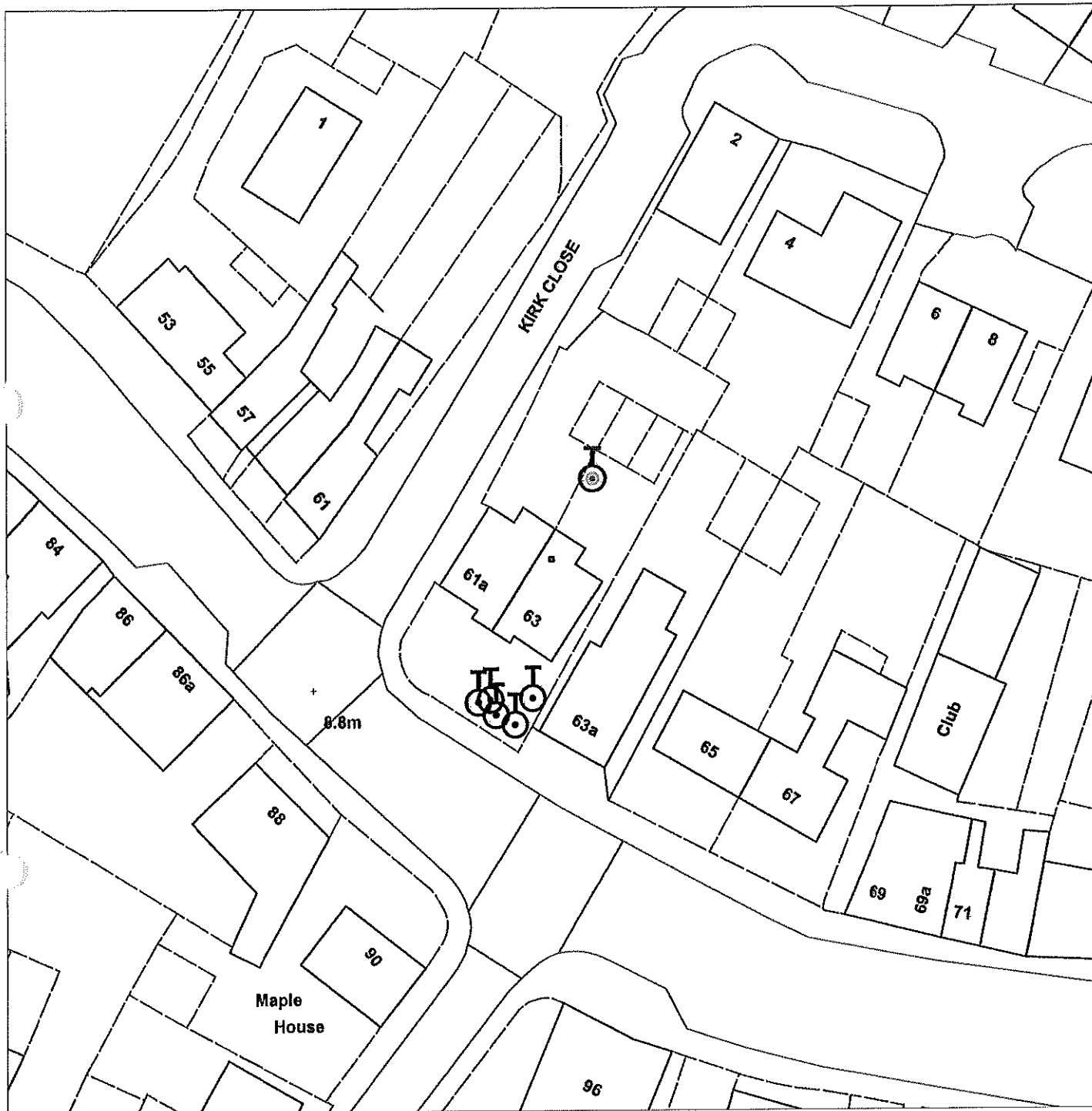

Scale : 1:531

Organisation	Hull City Council
Department	Planning
	Not Set
Date	22 April 2015

TPO 244
CLARONDON STREET.
TPO request to retain certain trees situated in car park;

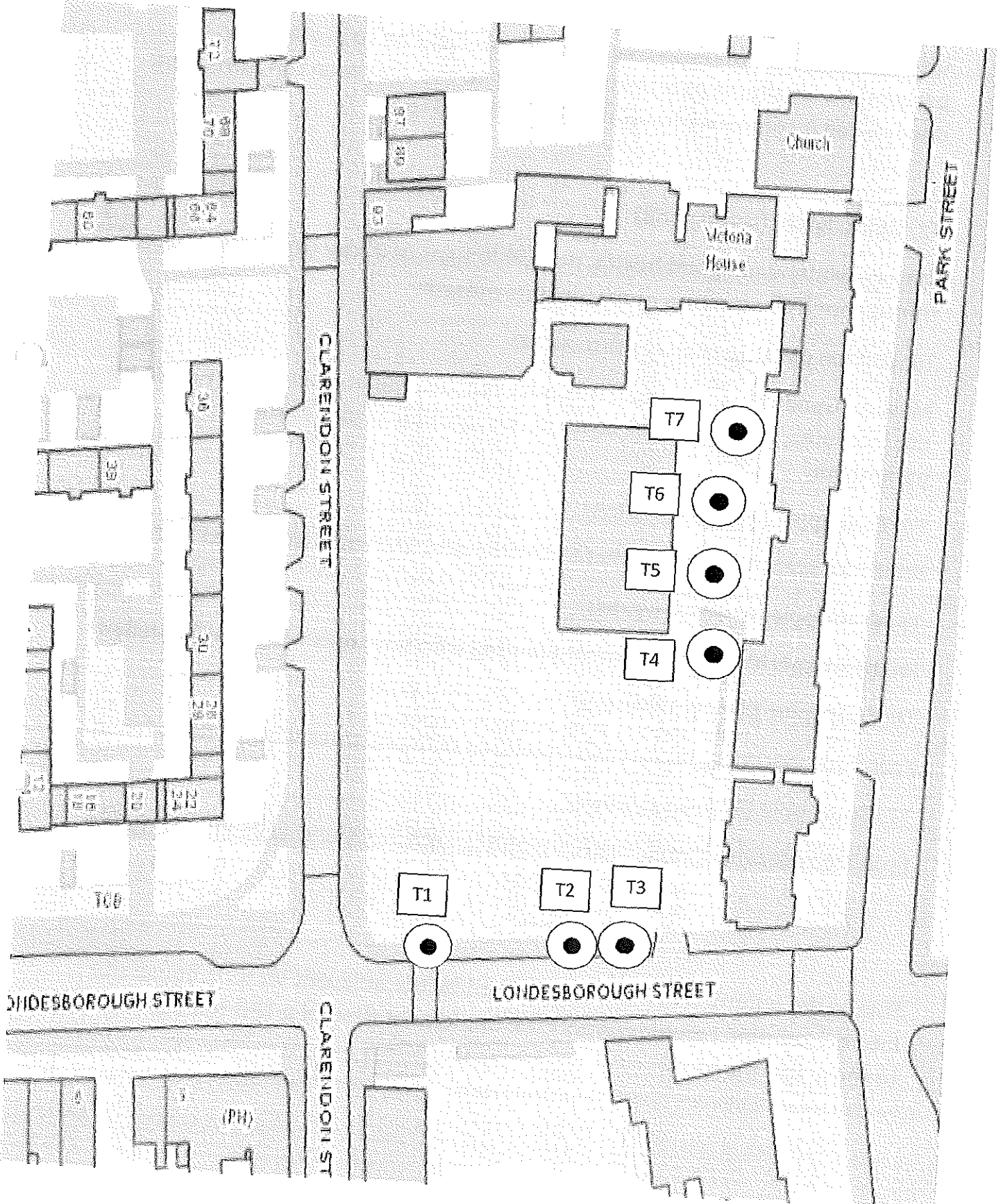

TPO 134 Colonial Street

Not Set

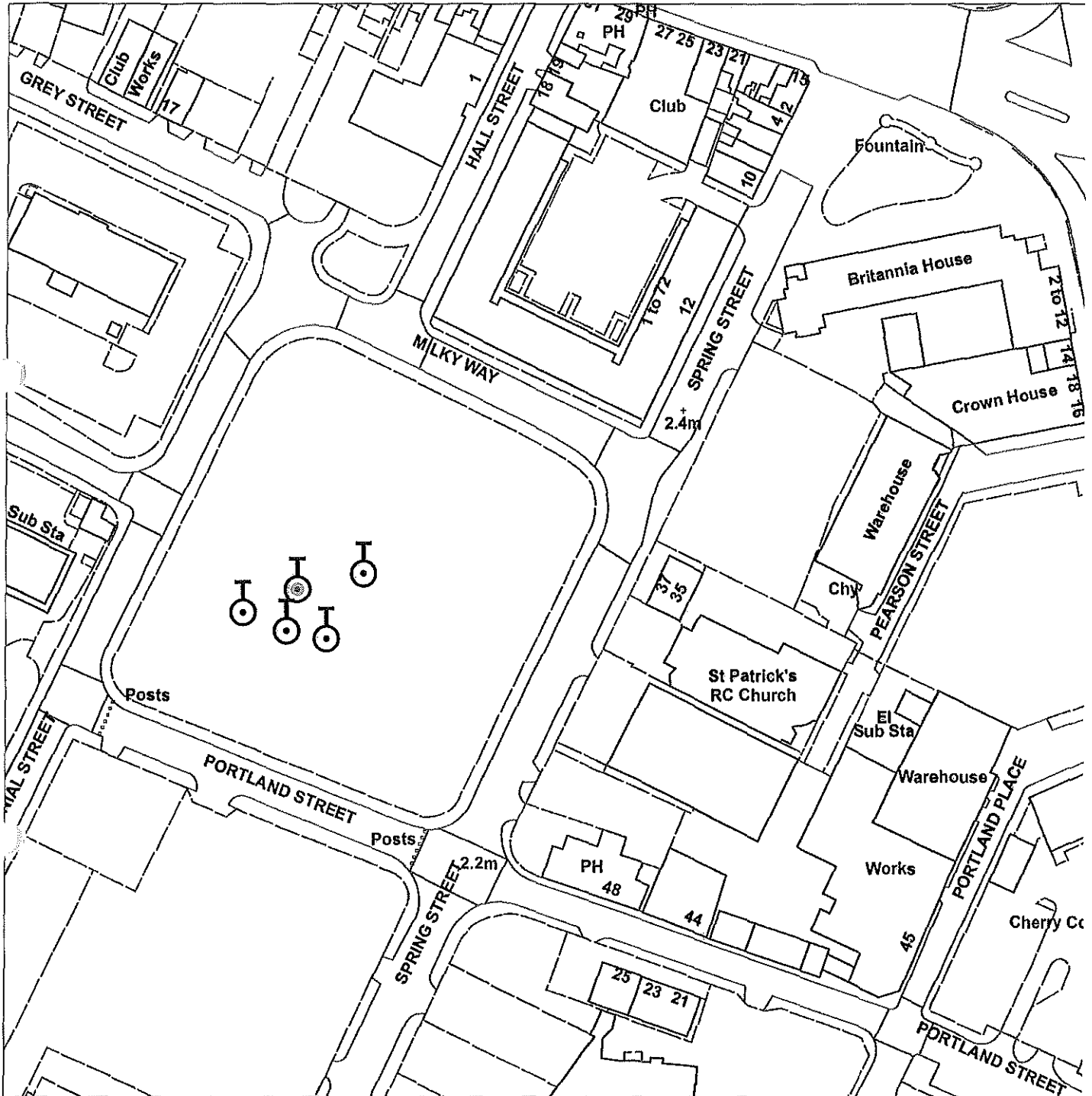

Scale : 1:1248

Organisation	Hull City Council
Department	Planning Department
	Not Set
Date	27 April 2015

179 COLTMAN STREET

ST PANCRAS CLOSE TPO 220

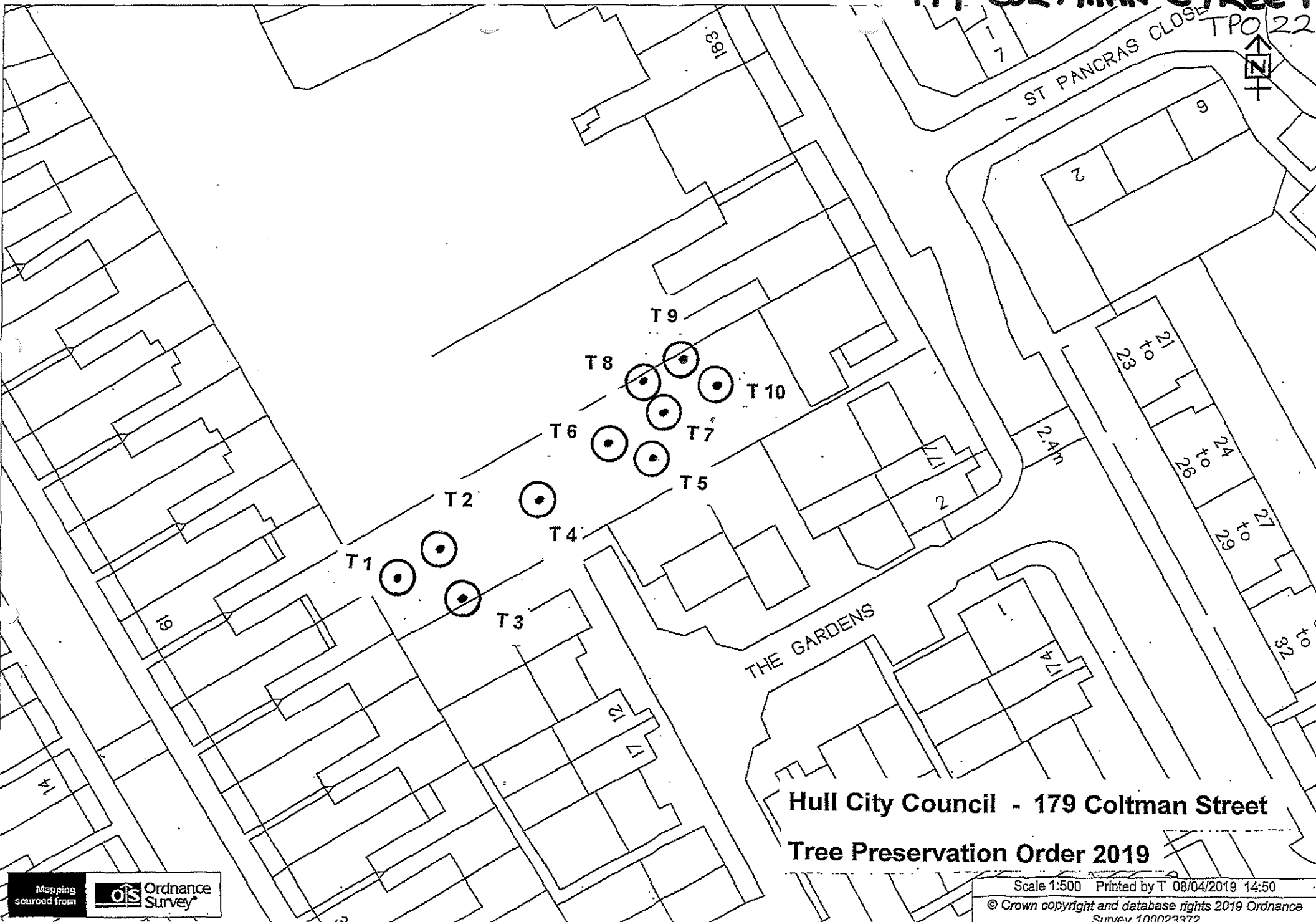

THE GARDENS

Hull City Council - 179 Coltman Street

Tree Preservation Order 2019



Scale 1:500 Printed by T 08/04/2019 14:50
© Crown copyright and database rights 2019 Ordnance Survey 100023372

TPO46 22 Convent Court

Not Set



Scale : 1:1063

Organisation	Hull City Council
Department	Planning Department
	Not Set
Date	22 April 2015



Hull
City Council

TPO No. 265

6 Coppice Side

T1— Dawn Redwood tree

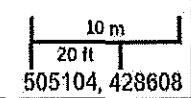

Tree Preservation Order No. 265 – 6 Coppice Side

Key:

T1 (identified on plan submitted with application as Tree 2)

Tree Species:

Dawn Redwood

TPO28 Cottingham Road/Beverley Road



Not Set



Scale : 1:1063

Organisation	Hull City Council
Department	Planning Department
	Not Set
Date	22 April 2015

TPO 197 29 Cottingham Road

Not Set

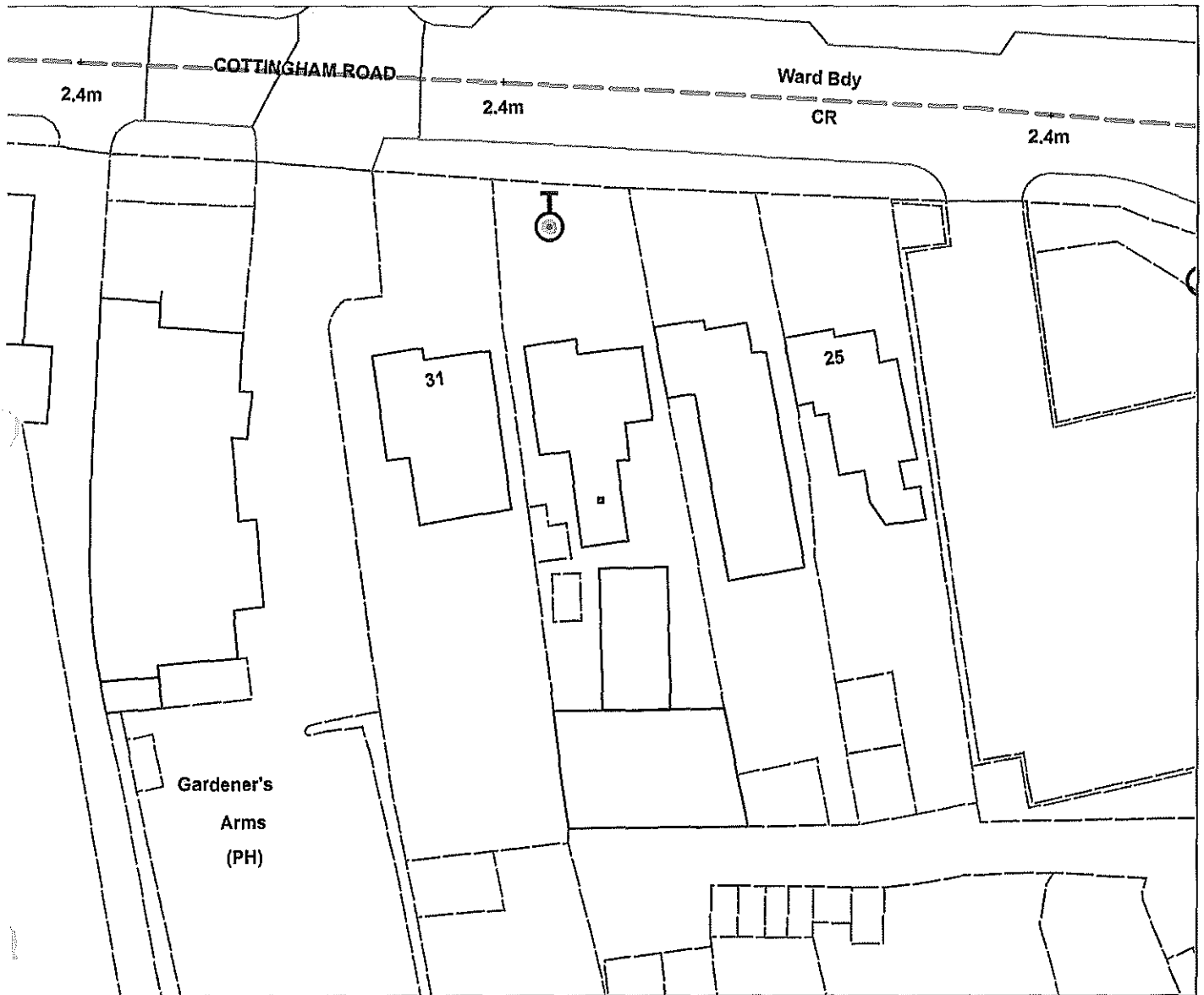

Legend

Scale 1:626

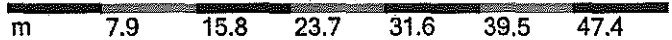

Reproduced from the Ordnance Survey map with the permission of the Controller of Her Majesty's Stationery Office © Crown Copyright 2000.

Unauthorised reproduction infringes Crown Copyright and may lead to prosecution or civil proceedings.

Organisation	Hull City Council
Department	Planning Department
Comments	Not Set
Date	27 April 2015
SLA Number	(100023372)

TPO 119 227 Cottingham Road



Not Set



Scale : 1:1063

Organisation	Hull City Council
Department	Planning Department
	Not Set
Date	27 April 2015

State

B1233 (COTTINGHAM ROAD)

LA

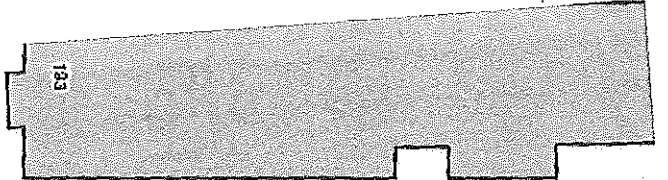

183

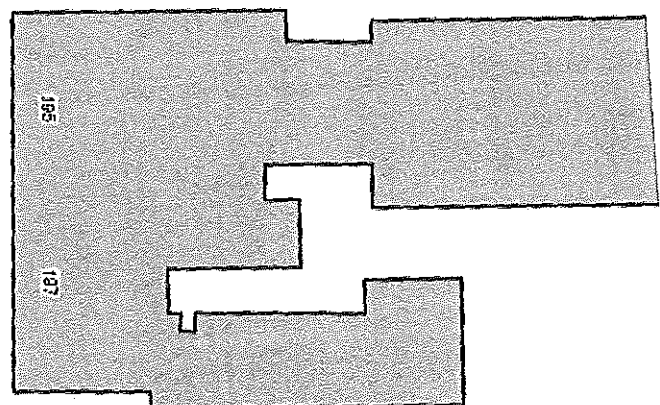

195

197

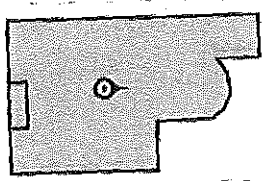
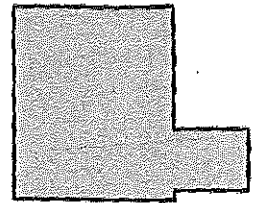

T1

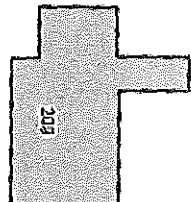
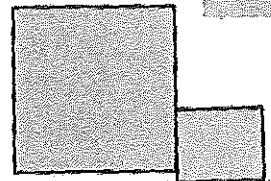
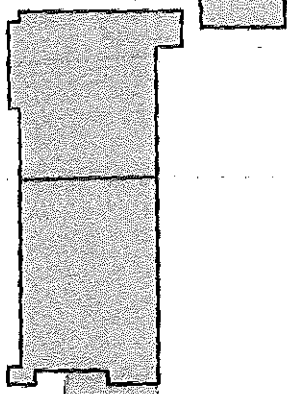

201

(c) Crown Copyright and database rights 2021 Ordnance Survey 100023372

TPO 252 Cottingham Road, 201

TPO32 167-193 Cottingham Road and 12-30 Newland

Doak
Not Set

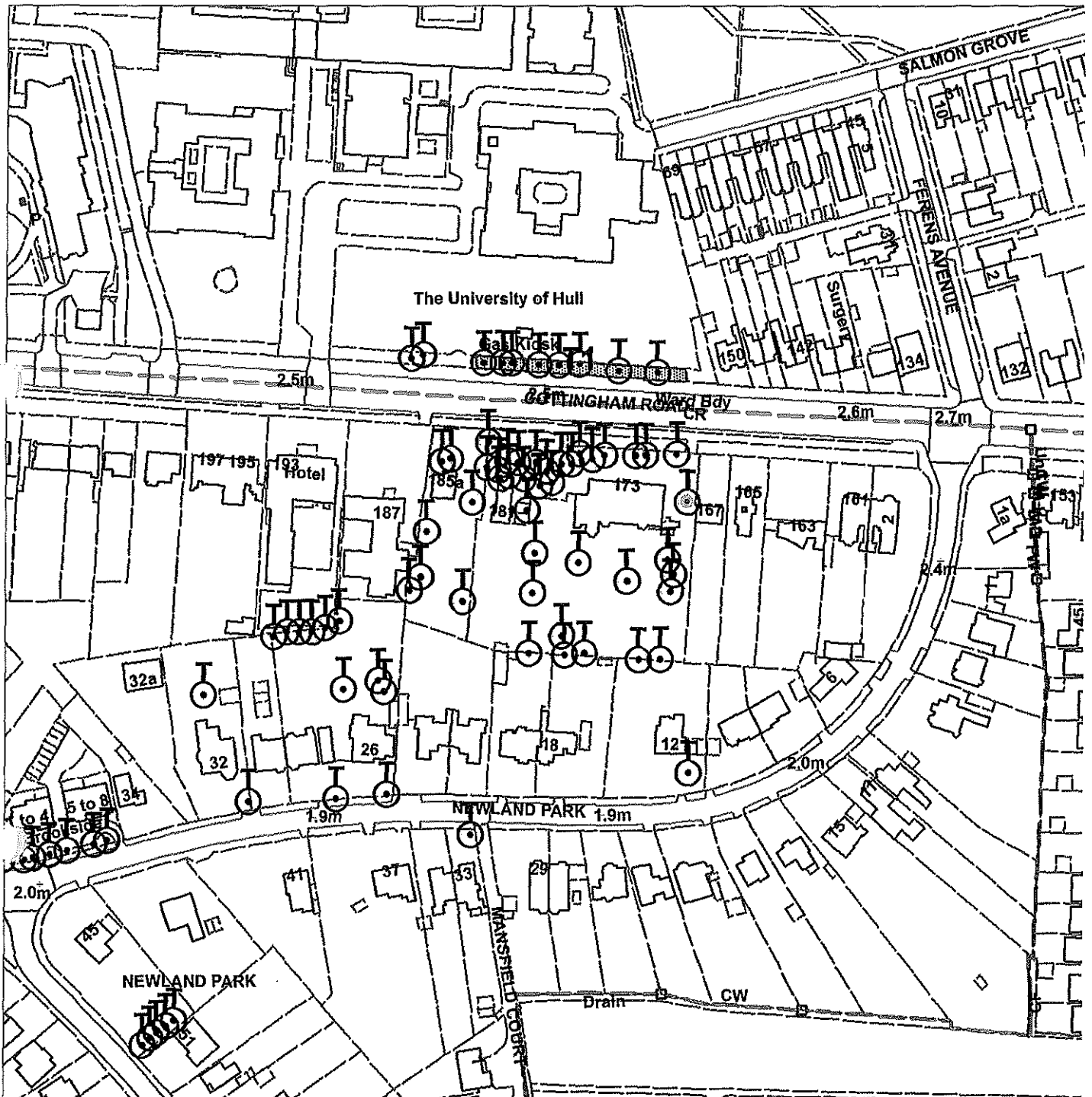

Scale : 1:2126

Organisation	Hull City Council
Department	Planning
	Not Set
Date	28 April 2015

TPO26 89 Cottingham Road

Not Set

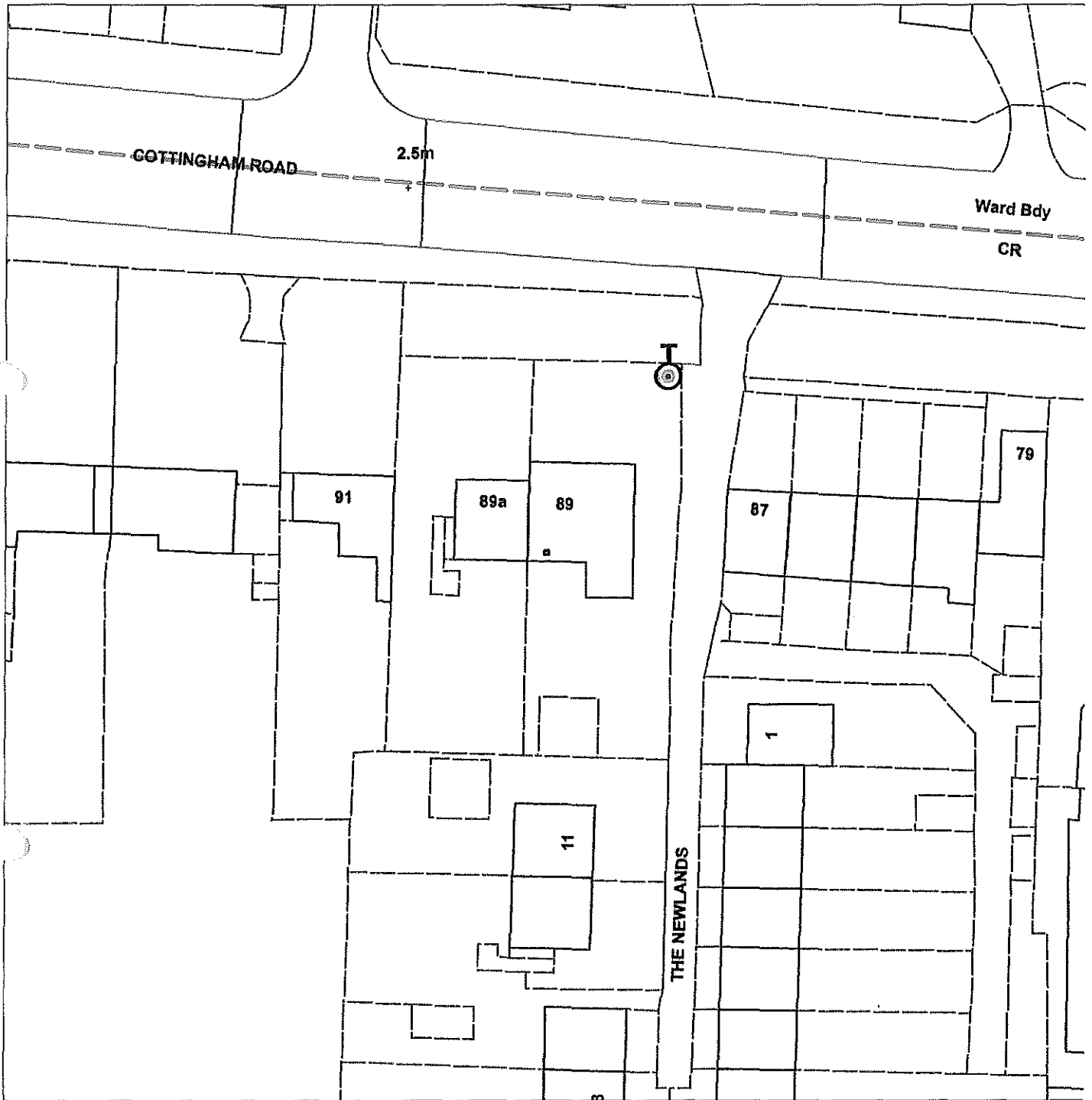

Scale : 1:531

Organisation	Hull City Council
Department	Planning Department
	Not Set
Date	22 April 2015

TPO52 Cottingham Road/Newland Avenue, Hull

Community Church
Not Set

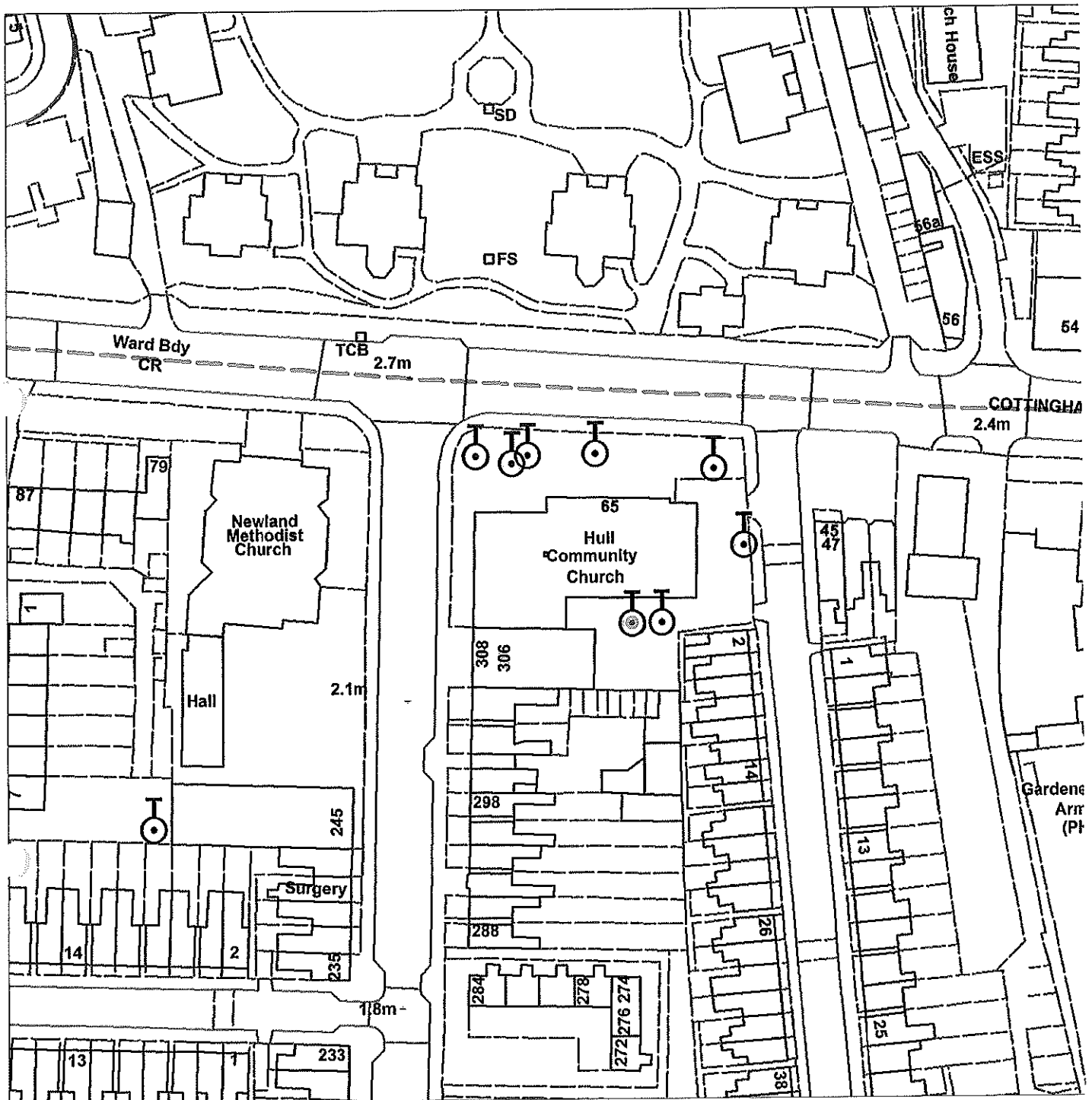

Scale : 1:1063

Organisation	Hull City Council
Department	Planning
	Not Set
Date	28 April 2015

TPO108 University of Hull, Cottingham Road



Not Set

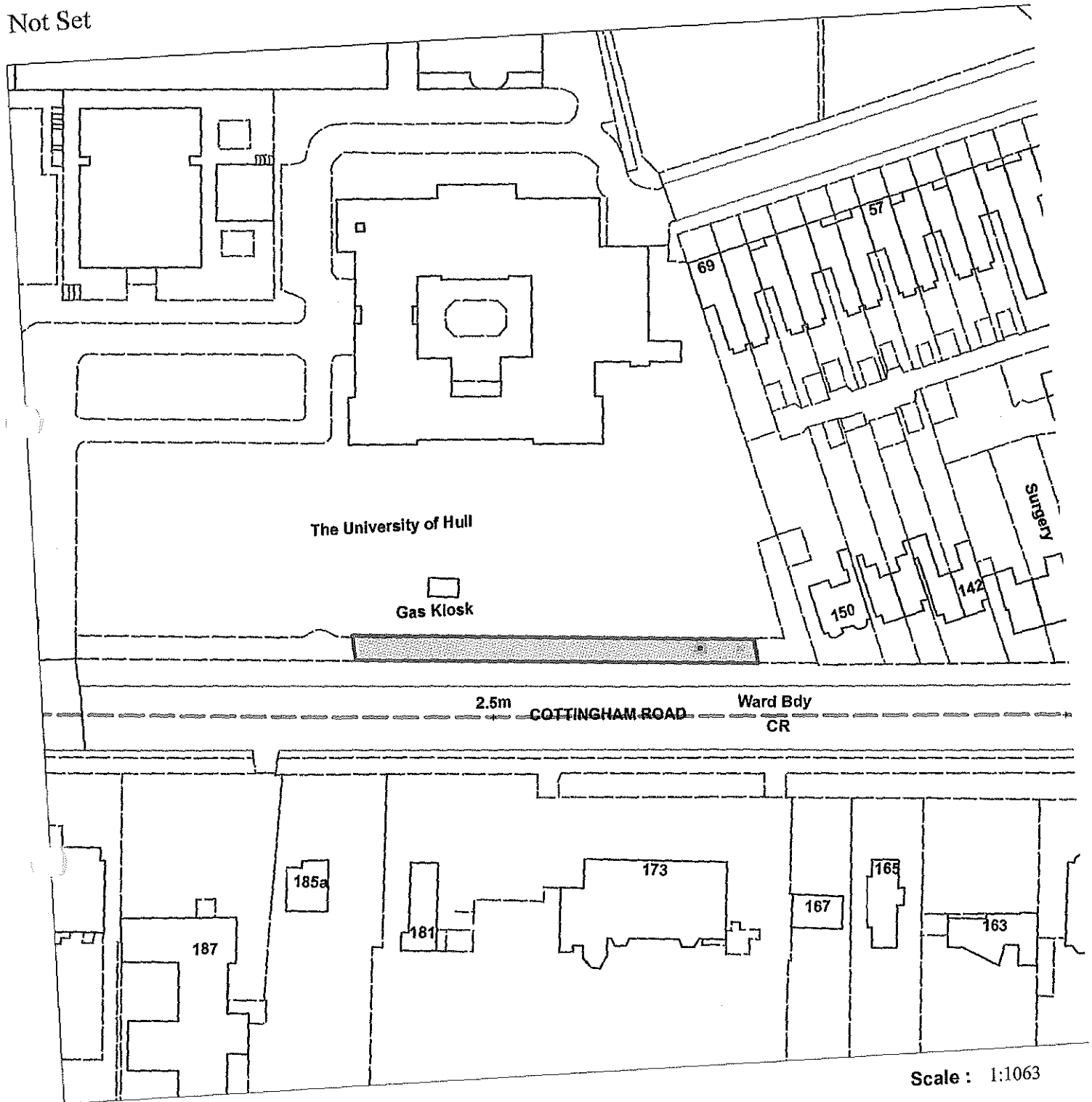

Scale : 1:1063

Organisation	Hull City Council
Department	Planning
	Not Set
Date	27 April 2015

TPO 126 Cottingham Road, North of

Not Set

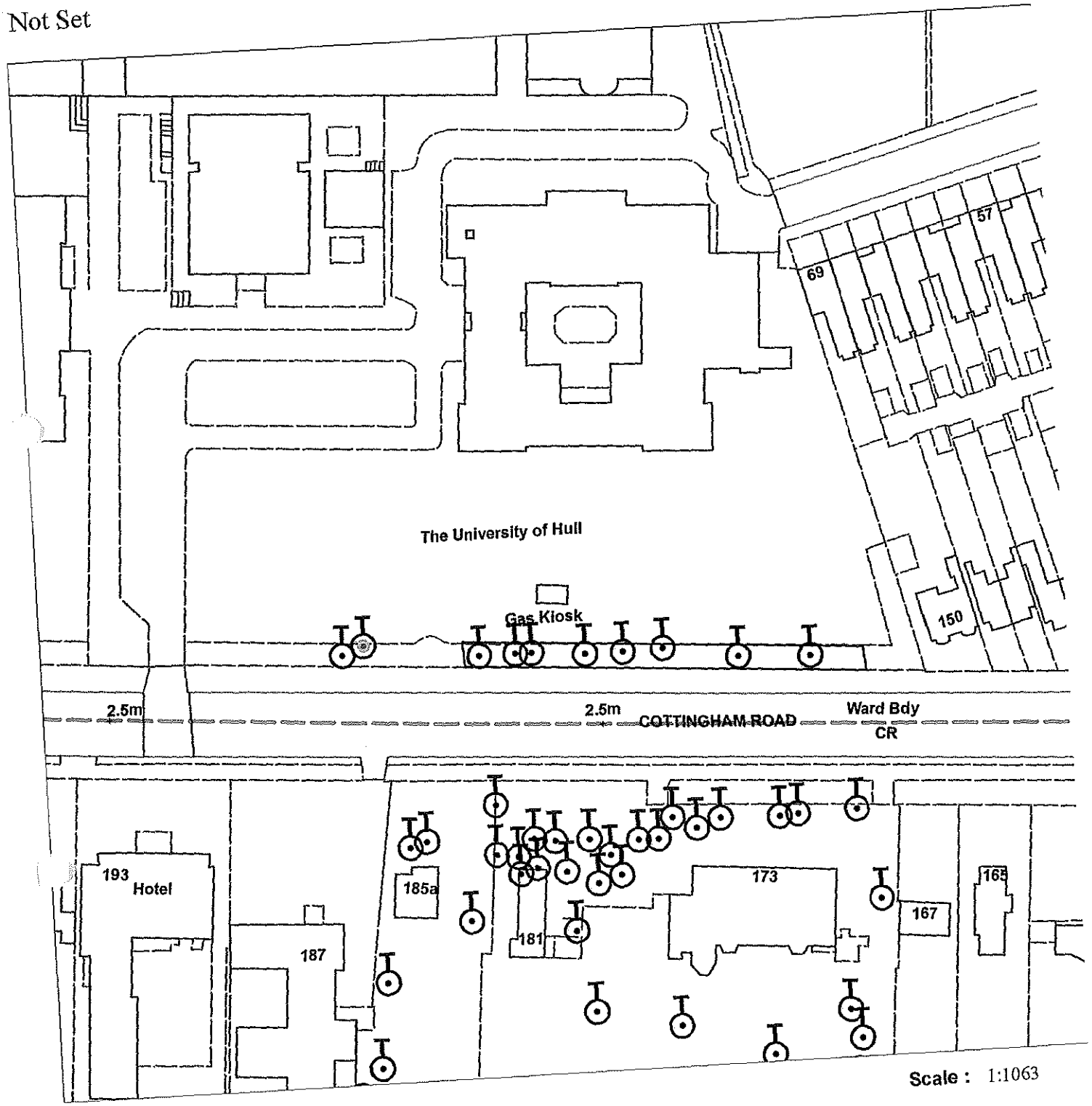

Scale : 1:1063

Organisation	Hull City Council
Department	Planning Department
	Not Set
Date	27 April 2015

TPO 243

Hull university wharfe building.

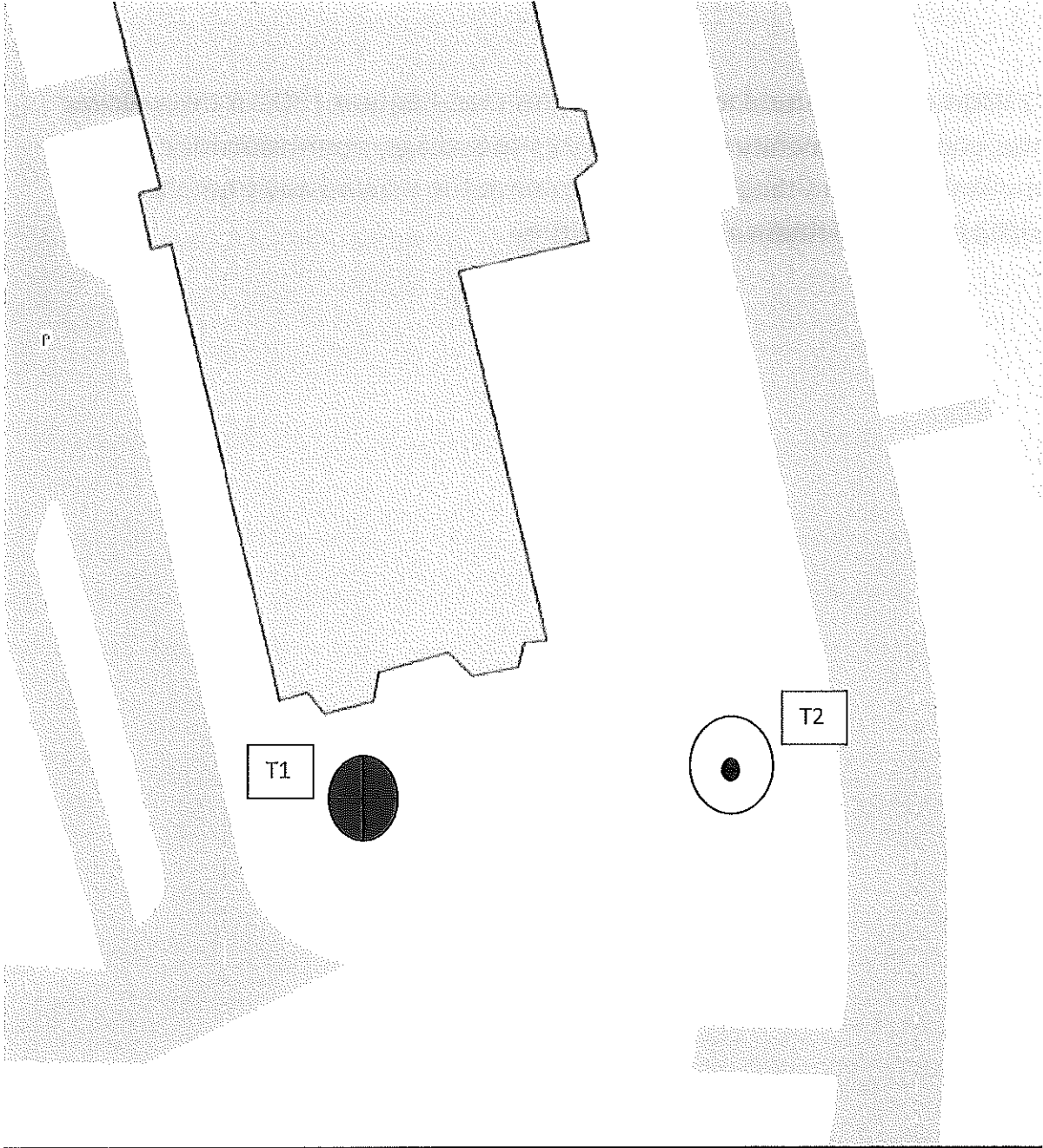

TPO 178 Cranbrook Avenue, St Marys College

Not Set

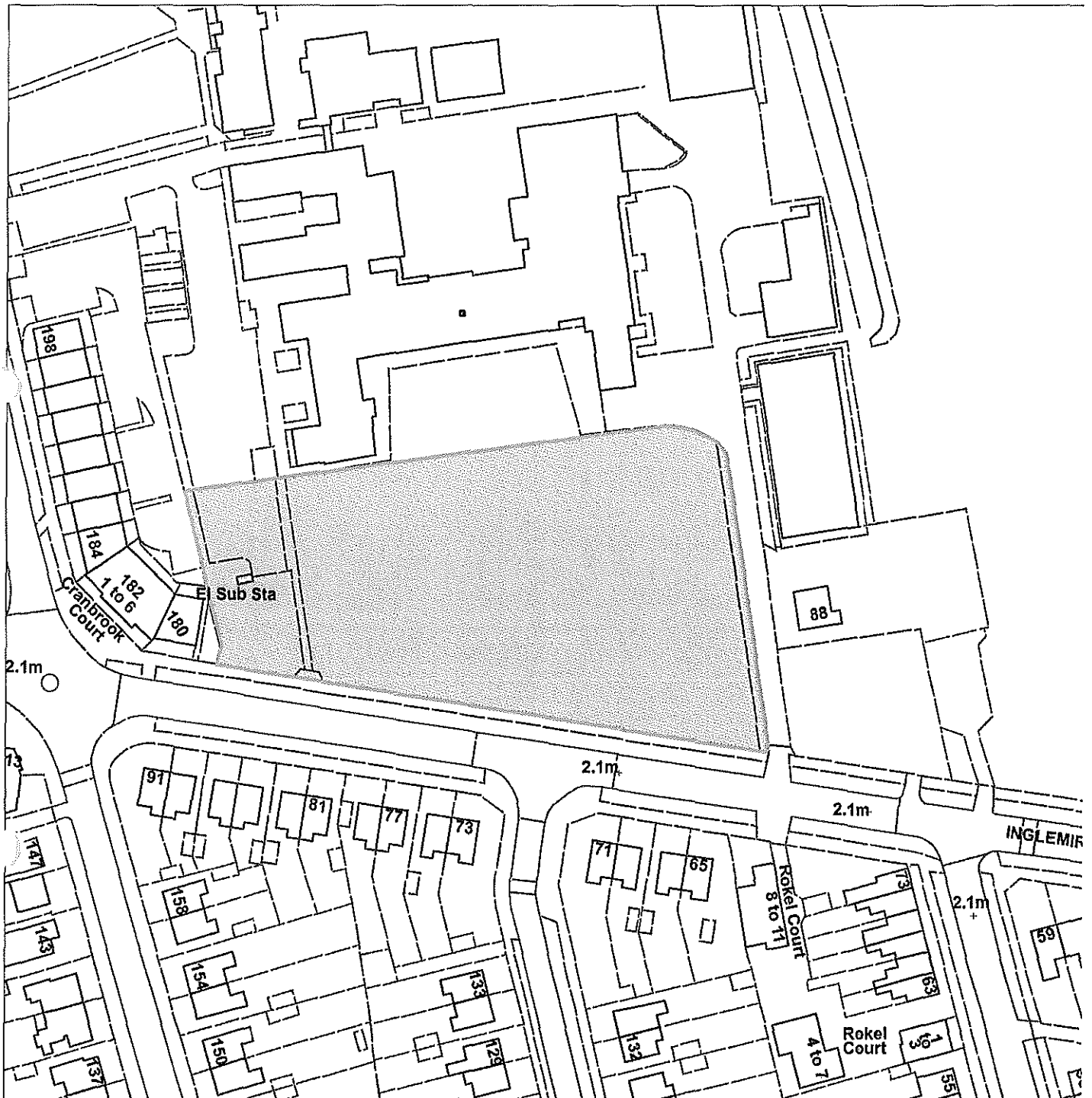

Scale : 1:1248

Organisation	Hull City Council
Department	Planning Department
	Not Set
Date	27 April 2015

TPO38 238-240 Cranbrook Avenue



Not Set



Scale : 1:531

Organisation	Hull City Council
Department	Planning Department
	Not Set
Date	22 April 2015

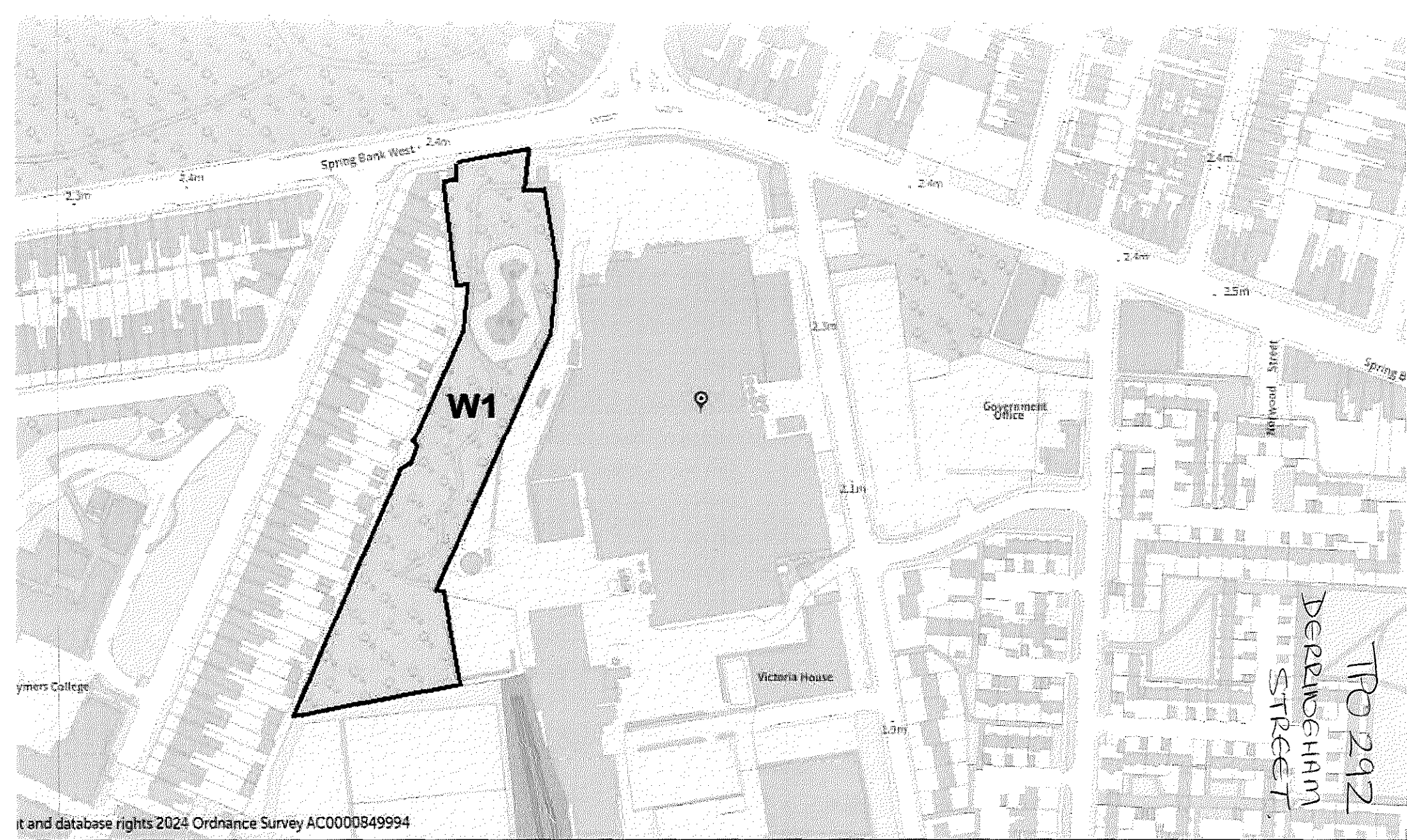

Map data and database rights 2024 Ordnance Survey AC0000849994

mixed hardwoods (mainly ash, sycamore, hawthorn, elm, cherry, hazel and holly)

